

- 1 Measure your 'start' length from the far left-hand side of the wall.

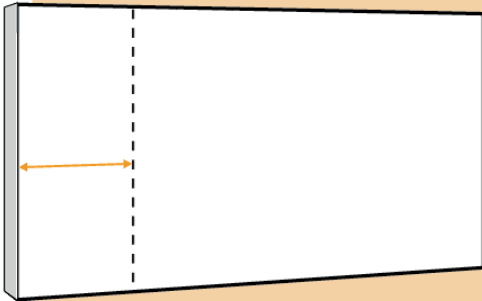

- 4 Smooth the sticky section of the Phototex into place, starting at the bottom and ending at the top. At this stage, remove all of your tape but do not trim anything.

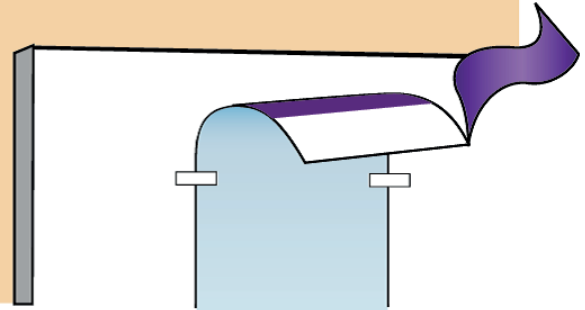

- 2 Using a plumb line or spirit level, draw a straight vertical line.

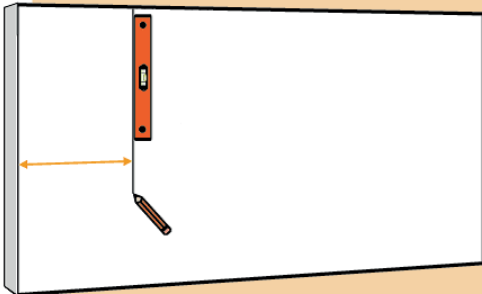

- 5 Slowly peel off the backing whilst smoothing down in a side to side motion as you go.

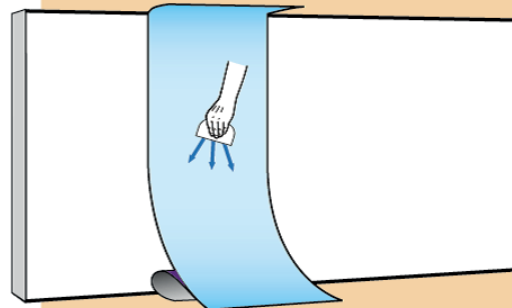

- 3 Use the white tape to hold 'strip 1' in place. Line up the top of the wall with the faint line at the top of the strip then position the left hand side of the strip on the line you have drawn.

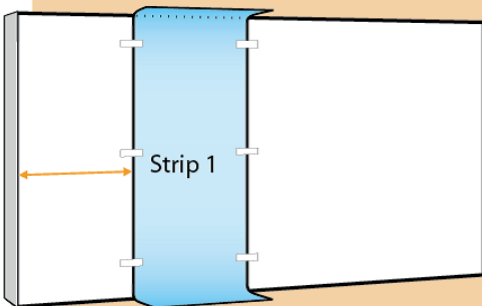

- 6 Position 'strip 2' using white tape in the same way as you did with 'strip 1'. Use faint line markings to guide you on the overlap.

